

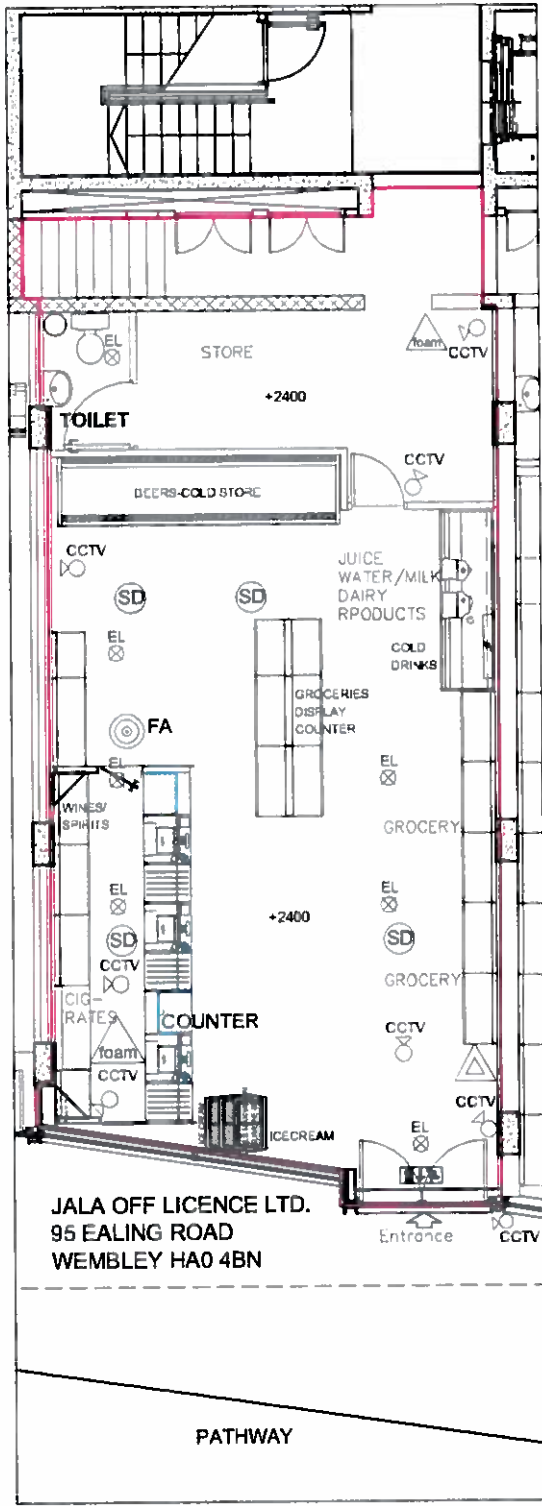







NOTES: Figured dimensions are to be used in preference to scaled dimensions.
 Contractors to verify all dimensions on site before commencing any work or shop drawing.
 Any discrepancies between these drawing and any other documents, drawings and the actual situation encountered on site should be conveyed to SAI Architects & Associates - Consultants and / or contract administrator immediately.
 This drawing is to be read in conjunction with other issued project documentation and drawings.
 All works to comply with the latest relevant code of practice, British Standards and Building Regulations and are to be the satisfaction of Local Statutory Authorities.
 No part of this drawing may be reproduced without the permission of SAI Architects & Associates - Consultants. This drawing is the property of Client. It must not be copied in whole or in part or distributed without their written permission. Copyright is reserved ©.



-  Fire extinguisher
6 Litre AFFF Foam spray
-  9 Litre Water stored pressure
-  6 kg (abc) powder
-  Emergency Lighting
-  Closed Circuit Television camera
-  Smoke Detectors underneath the structural existing slab
-  Fire alarm
-  Licensable Activities

GROUND FLOOR PLAN
 95 EALING ROAD
 @ SCALE 1 : 100



RIBA (Stage-A) from Inception to (L)-Occupation

REVISION			
Project JALA OFF LICENCE LTD., 95 Ealing Road, Wembley Middlesex, HA0 4BN. U.K			
Drawing Title EXISTING GROUND FLOOR PLAN			
Drawn	Checked	Scale	Date
JP	RJ	1:100	NOV 2017
Project No	Drawing No	Revision	
2017/10-06/PL	17/320/PL	*	

PREMISES LICENCE

A4

SAI ARCHITECTS & ASSOCIATES-CONSULTANTS

ARCHITECTURE TOWN PLANNING INTERIOR DESIGN PLANNING SUPERVISION
 62, Crownwalk, Wembley, Middlesex, London HA9 8HU
 Tel 020 8908 5746 E: saiarch@yahoo.com